



0148



RE-INSPECTION REPORT OF KNOWN ASBESTOS

for

THE SALVATION ARMY

of

Brookfield Chapel, 28 Brookfield Road, Portsmouth, PO1 5HZ

124584-274756

**Produced by SOCOTEC Asbestos Ltd,
a wholly owned subsidiary of SOCOTEC**

**Bretby Business Park, Ashby Road,
Bretby, Burton upon Trent,
Staffordshire DE15 0YZ
www.socotec.com**

Site
Brookfield Chapel, 28 Brookfield Road,
Portsmouth, PO1 5HZ

Customer:
The Salvation Army
South West Regional Office
Suite 27, Aztec Centre
Aztec West
Bristol
BS32 4TD



Surveyor : Naeem Farzaneh
Survey Date : 27/07/2019
Customer Contact : Tom Daniels

Consultant:
SOCOTEC Asbestos Limited

Unit D 2 Wilkinson Road,
Bankside Business Park,
Cirencester,
Gloucestershire
GL7 1YT

Tel +44 (0) 1285 700 593
Email esccirencester@socotec.com

Authorised by:



Naeem Farzaneh
Surveyor

Technical Review by:



Tracy Milnes
Project Manager

Report Issue date: 09/08/2019

EXECUTIVE SUMMARY & RECOMMENDATIONS

A Re-Inspection Survey of previous identified asbestos materials was carried out at Brookfield Chapel, 28 Brookfield Road, Portsmouth, PO1 5HZ.

Sample No.	Risk Score	Building	Area Description	Material	Material Risk	Priority Risk	Action	Timescale for Action
001	4	0001	Ground Floor - EXT-External	Soffit board to outside of Kitchen & Toilet	3	1	Manage	12 months

Table 2 Summary of Areas of Limited, Restricted or Partial Access

Area No	Building	Area Description	Reason
004	0001	Ground - Kitchen : Under Fitted Floor Covering	Access not possible at time of survey
005	0001	Ground - Lobby : Under Fitted Floor Covering	Access not possible at time of survey
007	0001	Ground - Toilets : Under Fitted Floor Covering	Access not possible at time of survey

The table above provides a list of locations of limited access at the time of inspection by the surveyor with reasons for access issues. Such areas must be assumed to contain asbestos until inspected.

FULL SURVEY REPORT

TABLE OF CONTENTS

EXECUTIVE SUMMARY & RECOMMENDATIONS

SECTION 1	INTRODUCTION
SECTION 2	SITE DESCRIPTION
SECTION 3	SPECIFIC NOTES
SECTION 4	SURVEY AND SAMPLING METHODOLOGY
SECTION 5	BULK SAMPLE ANALYSIS METHODOLOGY
SECTION 6	RISK ASSESSMENT

APPENDIX A	Site Register
APPENDIX B	Material Assessment Sheets
APPENDIX C	Drawings
APPENDIX D	Laboratory Test Certificate(s)
APPENDIX E	Definitions and Guidance Notes

SECTION 1 INTRODUCTION

- 1.1 SOCOTEC Asbestos Limited were instructed by Tom Daniels of The Salvation Army, to carry out an asbestos Re-inspection survey of Brookfield Chapel, 28 Brookfield Road, Portsmouth, PO1 5HZ in accordance with HSE document HSG 227 and in-house approved documented method SCI/ASB/027.

The previous survey or re-inspection was carried out on this site by ESG on 05/12/2012 Report Reference ASO3613-001

- 1.2 The scope of the works was to carry out a re-inspection of known asbestos materials in the premises, based on previous surveys, as instructed by the Customer. The extent and type of the asbestos containing materials on site was to be summarised in a written report including a detailed site register, survey report sheets and plans.

The scope of works was as follows: Re-inspection of known asbestos materials and a management survey of the high level ceiling void which will be accessed with a scaffold tower

The following areas were not accessed during the survey following initial discussions with the customer: Live electrics

- 1.3 The title to this report is vested in the Customer named but title to copyright is retained. The Contracts (Rights of Third Parties) Act 1999 does not apply to the contract with the Customer and the provisions of the said Act are hereby excluded.
- 1.4 The inspection report shall not be reproduced except in full without the approval of the inspection body and the Customer.
- 1.5 SOCOTEC Asbestos Ltd is accredited by UKAS as a Type C Inspection Body for surveying for asbestos in premises. Opinions, interpretations, priority risk assessments and total risk scores are outside the scope of accreditation.

SECTION 2 SITE DESCRIPTION

- 2.1 The site consisted of a single storey chapel built in the early 19th century..

Table 2.1: Summary of buildings surveyed and survey type at Brookfield Chapel, 28 Brookfield Road, Portsmouth, PO1 5HZ.

Property Ref / UPRN	Building Description	Survey Type
001	Single storey Chapel building	Reinspection

SECTION 3 SPECIFIC NOTES

- 3.1 The scope and terms of works were as agreed during the tender process with the Customer, including a discussion on areas of possible no-access. SOCOTEC Asbestos Limited shall not be held liable for the accuracy of 3rd party data provided for the basis of the Reinspection survey.
- 3.2 We confirm that in preparing this report that we have exercised all reasonable skill and care bearing in mind the project objectives, the agreed scope of works and prevailing site conditions.

- 3.3 Asbestos containing materials (ACMs) concealed behind other asbestos containing materials may not have been located during the original survey due to the original Scope of Works. It should be assumed that further asbestos containing materials may be present until proven otherwise.
- 3.4 Water absorption tests have not been carried out on board or cement materials and thus such materials which have been referred to within this report as asbestos insulating board (AIB) or asbestos cement are done so based solely upon their physical appearance and using the surveyors judgement. A water absorption measurement test, as detailed in paragraph 17 of L143 Work with materials containing asbestos CAR 2012, is required to determine whether a material is legally classified as asbestos cement or not. Asbestos cement in a dry state absorbs less than 30% water by weight.
- 3.5 This Re-Inspection Survey provides updates on the condition and accessibility of materials identified during previous inspections, and thus cannot be used as the basis for an asbestos removal specification. Note that all dimensions referred to in this report are approximate; the report should not be used for the preparation of priced measures.
- 3.6 All reasonable efforts were made to identify the presence of materials containing asbestos within the areas of the building. It is known that asbestos materials are frequently concealed within the fabric of buildings or within sealed building voids accordingly it is not possible to regard the findings of any survey as being definitive. The nature of the survey was a non-destructive inspection at key locations of accessible voids and areas

SECTION 4 SURVEY AND SAMPLING METHODOLOGY

4.1 Re-inspection of Known Asbestos Materials

- 4.1.1 The purpose of this inspection was to review existing documented data of the presence and extent of any ACMs and suspect ACMs in the building, re-assess their condition, and if necessary, collect representative samples and analyse for the presence of asbestos. Samples from each type of suspect ACM found which had not been previously identified by analysis were collected and analysed to confirm or refute the surveyor's judgement. If the material sampled was found to contain asbestos, other similar homogeneous materials used in the same way in the building have been strongly presumed to contain asbestos.

4.2 Abbreviations used in the text

- AWS Associated with sample. Visually consistent with sampled material.
- ACM Asbestos Containing Material
- NSR No sample required (Area has been inspected and no suspicious samples identified)
- NA No Access (Access not reasonably practicable)
- P Presumed to contain asbestos. Sample required to confirm absence or presence of asbestos in item
- CAR Control of Asbestos Regulations (2012)
- X All samples prefixed with an X were not taken by SOCOTEC Asbestos, however the data was provided by the client for inclusion within the report and the integrity of the data has been reviewed by SOCOTEC Asbestos Ltd in accordance with our internal procedures.

SECTION 5 BULK SAMPLE ANALYSIS METHODOLOGY

- 5.1 Bulk sample analysis was carried out in accordance with SOCOTEC Asbestos Limited's internal procedure SCI/ASB/007, based on the Health and Safety Executive publication HSG 248.

SECTION 6 RISK ASSESSMENT

6.1 Risk Assessment Methodology & Interpretation

- 6.1.1 Each location of asbestos has a risk assessment which is composed of two elements:

- Material Risk Assessment
- Priority Risk Assessment

- 6.1.2 The table below identifies the different between the two elements, their purpose and the guidance to which it relates and which SOCOTEC Asbestos Limited adhere.

Table 6.1: Summary of Risk Assessment

Risk Assessment Type	Purpose	Guidance and Algorithm used by SOCOTEC Asbestos Limited
Material Risk Assessment	Identification of the type and condition of the ACM and the ease with which it will release fibres if disturbed	<ul style="list-style-type: none">• HSG 264 – 'Asbestos – The survey guide.' – Appendix 4.• In house procedure SCI/ASB/001, based on the above
Priority Risk Assessment	Identification of the likelihood of disturbance	<ul style="list-style-type: none">• HSG 227 – 'A comprehensive guide to managing asbestos in premises'• In house procedure SCI/ASB/001, based on the above

- 6.1.3 The combined Material and Priority Risk Assessment scores provide a Total Risk Score for the asbestos material and may be used to determine the appropriate management procedure.

- 6.1.4 The Priority and Material Assessments were made based upon the conditions of the materials and their application at the time of survey/inspection, and as such SOCOTEC cannot accept liability for assessments provided when changes in condition and/or use have occurred subsequent to the survey. The duty holder should be aware that if the use of the building changes, then the assessment should be reviewed by a responsible person as part of the ongoing management plan, and this is the responsibility of the duty holder to manage.

Table 6.2 Material Risk Assessment Algorithm

Sample variable	Score	Example of scores
Product type (or debris from product)	1	Asbestos reinforced composites (plastics, resins, mastics, roofing felts, vinyl floor tiles, asbestos cement)
	2	AIB, millboards, textiles, gaskets, ropes and asbestos paper
	3	Thermal Insulation (e.g. pipe and boiler lagging), sprayed asbestos
Extent of damage /deterioration	0	Good condition, no visible damage
	1	Low damage, a few scratches, broken edges on board, tiles etc.
	2	Medium damage; significant breakage of materials or several small areas of damage revealing loose asbestos fibres
	3	High damage or delamination of materials, sprays and thermal insulation. Visible asbestos debris
Surface treatment	0	Composite materials: reinforced plastics, resins, vinyl tiles
	1	Enclosed sprays and lagging, AIB (with exposed face painted or encapsulated) asbestos cement sheets etc.
	2	Unsealed AIB, or encapsulated lagging and sprays
	3	Unsealed lagging and sprays
Asbestos type	0	No Asbestos Detected
	1	Chrysotile
	2	Amphibole excluding Crocidolite
	3	Crocidolite

Score	Potential to release asbestos fibres
10 or more	High
7-9	Medium
5-6	Low
4 or less	Very low

Table 6.3 Priority Risk Assessment Algorithm

Assessment Factor	Score	Examples of score variables
1. Normal Occupant Activity Main type of activity in area	0 1 2 3	Rare disturbance activity, (e.g. little used store room) Low disturbance activities, (e.g. office type activity) Periodic disturbance (e.g. industrial or vehicular activity which may contact ACMs) High levels of disturbance, (e.g. Fire door with AIB sheet in constant use)
2. Likelihood of Disturbance a) Location b) Accessibility c) Extent/Amount	0 1 2 3 0 1 2 3 0 1 2 3	Outdoors Large rooms or well ventilated areas Rooms up to 100m ² Confined spaces Usually inaccessible or unlikely to be disturbed Occasionally likely to be disturbed Easily disturbed Routinely disturbed Small amounts or items (e.g. strings, gaskets) ≤10m ² or ≤10m pipe run >10m ² to ≤50m ² or >10m to ≤50m pipe run >50m ² or >50m pipe run
Average Score = a + b + c / 3		
3. Human Exposure Potential a) Number of occupants b) Frequency of use of area c) Average time area in use	0 1 2 3 0 1 2 3 0 1 2 3	None 1 to 3 4 to 10 >10 Infrequent Monthly Weekly Daily <1 hour >1 to <3 hours >3 to <6 hours >6 hours
Average Score = a + b + c / 3		
4. Maintenance Activity a) Type of maintenance activity b) Frequency of maintenance activity	0 1 2 3 0 1 2 3	Minor disturbance (e.g. possibility of contact when gaining access) Low disturbance (e.g. changing light bulbs in AIB ceiling) Medium disturbance (e.g. lifting one or two AIB ceiling tiles to access a valve) High levels of disturbance (e.g. removing a number of AIB ceiling tiles to replace a valve or for re-cabling) ACM unlikely to be disturbed for maintenance <1 per year >1 per year >1 per month
Average Score = a + b / 2		
Total Priority Assessment Score = 1 + 2 + 3 + 4		

Appendix A

ASBESTOS RE-INSPECTION REGISTER



SOCOTEC

SITE REGISTER

Survey Report Ref: 124584-274756-0001 Site Address: Brookfield Chapel, 28 Brookfield Road, Portsmouth, PO1 5HZ
Building Reference / UPRN: 001 Building Address: 28 Brookfield Road
Client: The Salvation Army Date of Inspection: 27/07/2019

CONSTRUCTION REGISTER

Area No	Area Description	Floor	Walls	Ceiling	Other
001 & 002	Ground Floor - Ceiling Void above Main Hall & Office	Timber Parquet	Brick Masonry & plasterboard	Fibreboard ceiling tiles to underside of roof	MMMF Suspended Ceiling Tiles & fixed fibreboard ceiling



SOCOTEC

SITE REGISTER

Survey Report Ref: **124584-274756-0001** Site Address: **Brookfield Chapel, 28 Brookfield Road, Portsmouth, PO1 5HZ**
 Building Reference / UPRN: **001** Building Address: **28 Brookfield Road**
 Client: **The Salvation Army** Date of Inspection **27/07/2019**

Area No	Area Description	Material Description	Approx size of item	Sample or Associate Sample Reference	Material Risk			Material Risk Rating				Priority Risk				Overall Risk Score	Recommended Actions & Timescales
					Asbestos Type	Product Type	Extent of Damage	Surface Treatment				Normal Occupant Activity	Likelihood of Disturbance	Human Exposure Potential	Maintenance Activity		
005	Ground Floor - Lobby			No sample required													
006	Ground Floor - Hall			No sample required													
007	Ground Floor - Toilets			No sample required													
EXT	Ground Floor - External	Damp proof course	14 Linear m	003	0						N/A					N/A	No Action
EXT	Ground Floor - External	Soffit board to outside of Kitchen & Toilet	6 Linear M	001	1	1	0	1			3	0	0	0	1	1	4 Manage - 12 months
EXT	Ground Floor - External	Cable wrap to pipe	<1 m ²	002	0						N/A					N/A	No Action

KEY: All scores are subjective only and are based on information available at the time of the assessment. Inspections may be samples or associated samples (A/S). Comments and observations are outside the scope of UKAS accreditation. All information within this register must be read in conjunction with all other sections of the report. Please refer to Section 6.4 for information regarding Priority Risk Scores			
Asbestos Type	Product Type	Extent of Damage	Areas of No / Limited Access
0 = No asbestos detected in sample	0 = No asbestos detected in sample	0 = No visible damage	FS = Fixed Sealing SD = Service Ducts FD = Floor Ducts SB = Structural Boxings SV = Structural Voids DL = Dry Lining or Boxings FC = Fixed Ceilings UC = Under Fitted Floor Covering CV = Ceiling Voids
1 = Chrysotile (white) asbestos	1 = Plastics, mastics, felts, vinyl floor tiles, paints, dec. finishes, cement etc.	1 = Few scratches / marks, broken edges etc.	PV = Partition Wall Void SC = Above Suspended Ceiling LA = Lint / Allot EE = Electrical Equip. HE = Heating Equipment FP = Fixed Paneling DF = Within Door Frame WF = Within Window Frame HL = High Level PE = Plant / Equipment (includes lift machinery)
2 = Amosite (brown) asbestos	2 = A/B, textiles, gaskets, rope, paper etc.	2 = Sig breakage / many small areas of damage to friable material	
3 = Crocidolite (blue) asbestos	3 = lagging, spray coatings, loose asbestos etc	3 = High damage / visible debris	

**SOCOTEC****SITE REGISTER**

Survey Report Ref: 124584-274756-0001 Site Address: Brookfield Chapel, 28 Brookfield Road, Portsmouth, PO1 5HZ

Building Reference / UPRN: 001 Building Address: 28 Brookfield Road

Date of Inspection 27/07/2019 Client: The Salvation Army

ASBESTOS REGISTER

Area No	Area Description	Material Description	Approx size of item	Sample or Associate Sample Reference	Material Risk				Material Risk Rating				Priority Risk				Overall Risk Score	Recommended Actions & Timescales	
					Asbestos Type	Product Type	Extent of Damage	Surface Treatment				Normal Occupant Activity	Likelihood of Disturbance	Human Exposure Potential	Maintenance Activity	Priority Risk Rating	Overall Risk Score	Recommended Actions & Timescales	
001	Ground Floor - Main Hall			No sample required														Inspection Required in Limited Access Area / Ceiling void : Limited - Two suspended ceilings >4m. Too high to access.	
001&002	Ground Floor - Ceiling Void above Main Hall & Office	Debris within ceiling void	Small Amounts	004	0											N/A	N/A	No Action	Inspection Required in Limited Access Area / Ceiling void : Limited - Two suspended ceilings >4m. Too high to access.
002	Ground Floor - Office			No sample required														Inspection Required in Limited Access Area / Ceiling void : Limited - Two suspended ceilings >4m. Too high to access.	
003	Ground Floor - Toilets			No sample required															
004	Ground Floor - Kitchen			No sample required															

KEY: All scores are subjective only and are based on information available at the time of the assessment. Inspections may be samples or associated samples (AWS). Comments and observations are outside the scope of UKAS accreditation. All information within this register must be read in conjunction with all other sections of the report. Please refer to Section 8.4 for information regarding Priority Risk Scores			
Asbestos Type	Product Type	Extent of Damage	Areas of No Limited Access
0 = No asbestos detected in sample	0 = No asbestos detected in sample	0 = No visible damage	FS = Fixed Sealing SD = Service Ducts FV = Floor Voids FD = Floor Ducts SB = Structural Boxings SV = Structural Voids DL = Dry Lining or Boxings FC = Fixed Ceilings UC = Under Fitted Floor Covering CV = Ceiling Voids
1 = Chrysotile (white) asbestos	1 = Plastics, mastic, felt, vinyl floor tiles, paint, dec. finishes, cement etc	1 = Few scratches / marks, broken edges etc	PV = Partition Wall Void SC = Above Suspended Ceiling LA = Loft / Attic EE = Electrical Equip HE = Heating Equipment FP = Fixed Paneling DF = Within Door Frame WF = Within Window Frame HL = High Level PE = Plant / Equipment (includes lift machinery)
2 = Amosite (brown) asbestos	2 = A/B, textiles, gaskets, rope, paper etc	2 = Sig breakage / many small areas of damage to friable material	
3 = Crocidolite (blue) asbestos	3 = lagging, spray coatings, loose asbestos etc	3 = High damage / visible debris	

Appendix B

MATERIAL ASSESSMENT SHEETS



SOCOTEC

MATERIAL ASSESSMENT SHEET

SITE / AREA / INSPECTION DETAILS

Client:	The Salvation Army	Area No:	001 & 002
Site Address:	Brookfield Chapel, 28 Brookfield Road, Portsmouth, PO1 5HZ	Floor:	Ground
Building:	001	Area Description:	Ceiling Void above Main Hall & Office
Building Address:	28 Brookfield Road	Material Description:	Debris within ceiling void
		Survey Report Reference:	124584-274756-0001



ASSESSMENT

Material Risk: N/A

Asbestos Type: 0 - No asbestos detected

Product Type:

Extent of Damage:

Surface Treatment:

Priority Risk: N/A

Normal Occupant Activity:

Likelihood of Disturbance:

Human Exposure Potential:

Maintenance Activity :

Sample No: 004

Position: Internal

Approx Size of Item: . Small Amounts

COMMENTS AND RECOMMENDATIONS:

Timescale for Recommendation : No action

Recommendation: No further action required

Comments: Located sporadically throughout void

Total Risk Score: N/A



SOCOTEC

MATERIAL ASSESSMENT SHEET

SITE / AREA / INSPECTION DETAILS

Client:	The Salvation Army	Area No:	EXT
Site Address:	Brookfield Chapel, 28 Brookfield Road, Portsmouth, PO1 5HZ	Floor:	Ground
Building:	001	Area Description:	External
Building Address:	28 Brookfield Road	Material Description:	Soffit board to outside of Kitchen & Toilet
		Survey Report Reference:	124584-274756-0001



ASSESSMENT

Material Risk:	3
Asbestos Type:	1 - Chrysotile
Product Type:	1 - Asbestos composites, decorative finishes, AC
Extent of Damage:	0 - Good
Surface Treatment:	1 - Enclosed sprays and lagging, AIB, AC sheets etc
Priority Risk:	1
Normal Occupant Activity:	0 - Rare Disturbance
Likelihood of Disturbance:	0 - Very Low Likelihood of Disturbance
Human Exposure Potential:	0 - Very Low Human Exposure Potential
Maintenance Activity :	1 - Low Risk Maintenance Activity

Sample No:	001
Position:	External
Approx Size of Item:	6 Linear M

COMMENTS AND RECOMMENDATIONS:

Timescale for Recommendation : 12 months

Recommendation:	Manage
------------------------	--------

Comments:	PVC soffits also present
------------------	--------------------------

Total Risk Score:	4
--------------------------	----------

Appendix C

DRAWINGS

Client	The Salvation Army			Y:	Inspection Reference Location
Site Address	Brookfield Chapel, 28 Brookfield Road, Portsmouth, PO1 5HZ				Asbestos Present
Survey Reference	124584/274756				Inaccessible Areas
Date of Survey/Inspection	27/07/2019			S=Sample	Beyond Remit of Survey
Surveyors	N.Farzaneh			AWS = As With Sample	
	PAGE 1 OF 1			P = Presumed	
	Not to Scale				

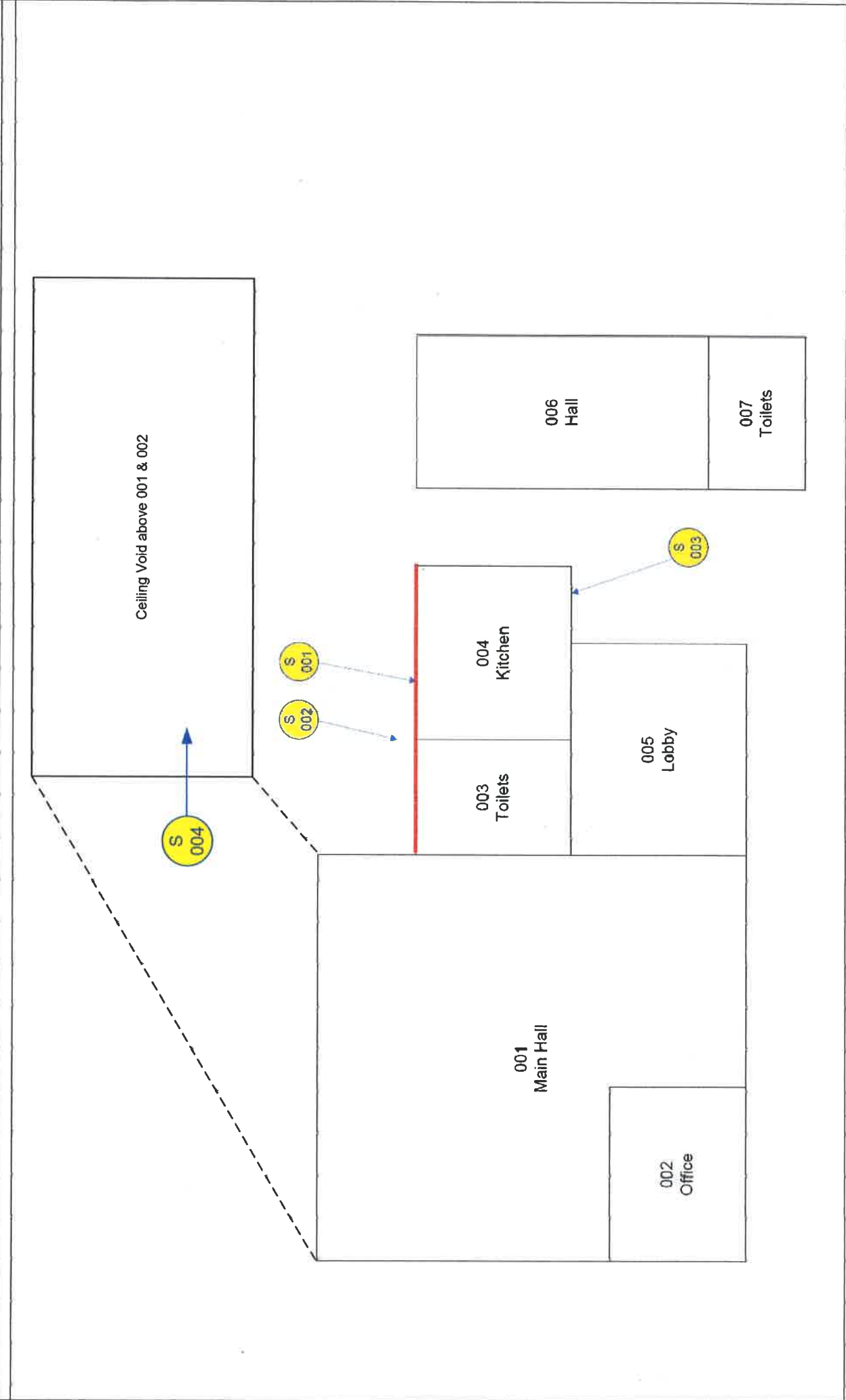

Appendix D

LABORATORY TEST CERTIFICATE(S)

**SOCOTEC****CERTIFICATE FOR IDENTIFICATION OF
ASBESTOS FIBRES****SOCOTEC Asbestos Limited**Unit 5, Bridgend Industrial Estate,
New Street
Bridgend
CF31 3UDTelephone: 01656 646588
E-mail:
socotec@bridgend.socotec.com

Client	The Salvation Army	Delivered/Collected	Collected
Address	South West Regional Office, Suite 27, Aztec Centre, Aztec West, Bristol, BS32 4TD	Analysis Report No	W134927
Attention	Tom Daniels	Report Date	29/Jul/2019
Site Address	Brookfield Chapel, 28 Brookfield Road, Portsmouth, PO1 5HZ	Site Ref No	124584-274756
Date Sample Taken	27/07/2019	Page No	1 of 1
Date Sample Received	29/07/2019	No of Samples	1
Date of Analysis	29/07/2019		

SOCOTEC Asbestos SAMPLE No	CLIENT SAMPLE No	SAMPLE LOCATION & DESCRIPTION*	FIBRE TYPE DETECTED	ANALYSIS No
004		Ground Floor - Ceiling Void above Main Hall & Office 001& 002 - Debris within ceiling void	NADIS	124584-274756-0001-004

KEY: NADIS - No Asbestos Detected in Sample.

All samples will be retained for a minimum of 6 Months.

Analysed by:	Name: Danielle Jones	Authorised signature:	Name: PHILIP EMERY
	Position: Asbestos Bulk Analyst		Position: Bulk Analyst

BULK005-VER 15 18-OCT 2017

Samples of material referenced above have been examined using our internal procedure SCI/ASB/007, based on HSE's HSG248, Asbestos: The Analysts guide for sampling, analysis and clearance procedures. If samples have been DELIVERED, the site address and actual sample location is as given by the client at the time of delivery. SOCOTEC Asbestos Limited is not responsible for the accuracy or competence of the sampling by third parties, and can therefore not be held responsible for any interpretation of the results shown. The inspection report shall not be reproduced except in full without the approval of the inspection body and the client. *Please note that the sample description, material type and comments/observations are opinions and therefore not within the scope of UKAS accreditation.



Appendix E

DEFINITIONS AND GUIDANCE NOTES

Your Survey Recommendations

A.1 Recommendations are made based upon each items assessed potential for fibre release as recommended by the guidance published by the Health and Safety Executive.

A.2 Definition of terms for actions detailed within this report:

i. Add to inspection: Provision of a policy of 12 monthly inspections together with procedures, including but not exclusively limited to action should deterioration be observed, as well as training for staff and persons possibly coming into contact with the material.

ii. Manage: Provision of a policy of regular inspection together with procedures, whilst continually monitoring the condition of the material for further deterioration.

iii. Manage & Label: Process and provision for the fixing of labels - standard 'red A' label as per Schedule 2 of the Control of Asbestos Regulations (CAR), to the surface of the material to warn of the hazard.

iv. Control/Restrict access: Material in a condition and position that is likely to cause fibre release should it be disturbed. Immediate action to implement procedure to restrict access to area via physical controls.

v. Repair: Addition of a seal to the material to prevent the further deterioration and breakdown of the material. This action should also be carried out with labelling.

vi. Encapsulate: Provision of paint type coating to effect a continuous seal to surface of the material and thereby prevent fibre release.

vii. Remove: Complete removal of the material under controlled conditions so as to comply with CAR.

CERTIFICATE FOR IDENTIFICATION OF ASBESTOS FIBRES

SOCOTEC Asbestos Limited

Unit 5, Bridgend Industrial Estate,
New Street
Bridgend
CF31 3UD

Telephone: 01656 646588
E-mail:
socoteccirencester@socotec.com

Client	The Salvation Army	Delivered/Collected	Collected
Address	South West Regional Office, Suite 27, Aztec Centre, Aztec West, Bristol, BS32 4TD	Analysis Report No	W134927
Attention	Tom Daniels	Report Date	29/Jul/2019
Site Address	Brookfield Chapel, 28 Brookfield Road, Portsmouth, PO1 5HZ	Site Ref No	124584-274756
Date Sample Taken	27/07/2019	Page No	1 of 1
Date Sample Received	29/07/2019	No of Samples	1
Date of Analysis	29/07/2019		

SOCOTEC Asbestos SAMPLE No	CLIENT SAMPLE No	SAMPLE LOCATION & DESCRIPTION*	FIBRE TYPE DETECTED	ANALYSIS No
004		Ground Floor - Ceiling Void above Main Hall & Office 001& 002 - Debris within ceiling void	NADIS	124584-274756-0001- 004

KEY: NADIS - No Asbestos Detected in Sample.
All samples will be retained for a minimum of 6 Months.

Analysed by:	Name: Danielle Jones	Authorised signature:	Name: PHILIP EMERY
	Position: Asbestos Bulk Analyst		Position: Bulk Analyst

BULK005-VER 15 18-OCT 2017

Samples of material referenced above have been examined using our internal procedure SCI/ASB/007, based on HSE's HSG248, Asbestos: The Analysts guide for sampling, analysis and clearance procedures. If samples have been DELIVERED, the site address and actual sample location is as given by the client at the time of delivery. SOCOTEC Asbestos Limited is not responsible for the accuracy or competence of the sampling by third parties, and can therefore not be held responsible for any interpretation of the results shown. The inspection report shall not be reproduced except in full without the approval of the inspection body and the client. *Please note that the sample description, material type and comments/observations are opinions and therefore not within the scope of UKAS accreditation.