

BENEFICIAL BUILDING

28 Paradise Circus, Birmingham B1 2BJ

GROUND FLOOR
RETAIL/LEISURE
OPPORTUNITY

4,350 SQ FT (404 SQ M)



KEY FEATURES

- City centre ground floor premises
- Proposed Class E consent
- Prominent corner location
- Immediate area subject to significant urban regeneration
- Birmingham to host Commonwealth games in 2022
- Available to let on new EFRI lease
- Open plan accommodation
- Situated below residential co living space
- Ground: 4,350 sq ft (404 sq m)
(can be split or extended to 6,000 sq ft depending on requirement)
- Rent on application
- Nearby occupiers include Dishoom, Vinoteca, and the extensive range of high end retail and leisure amenities at the The Mailbox

LOCATION AND SITUATION

Situated on the prominent corner position of Paradise Circus and Suffolk Street Queensway; Beneficial Building sits adjacent the Paradise Development which is one of the biggest development projects Birmingham has seen for a generation and will bring a vibrant mixed use scheme to the city with commercial, retail, leisure and hotel space in addition to a greatly enhanced public realm.

PLANNING

The premises will benefit from Class E use within the Use Classes Order 1987 (as amended) on receipt of planning.

EPC

An EPC assessment will be carried out upon completion.

BUSINESS RATES

RV to be assessed upon completion.

TERMS

The property is available to let by way of a new (effectively) full repairing and insuring lease for a term to be agreed.

Rent on application.

There will be a service charge contribution toward the common parts of the property.

LEGAL FEES

Each party to bear their own legal costs incurred.

VAT

Rents and prices are quoted exclusive of and are subject to VAT.

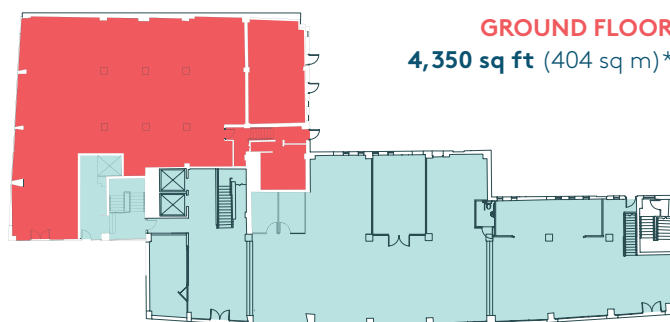

■ Retail Space
■ Office Space

For indicative purposes. Not to scale.
*Approximate Gross Internal Area (GIA).
Space can be extended to C.6,000 sq ft depending on requirement.



FURTHER INFORMATION

Please contact the joint agents:

CBRE

Andrew Jackson
Andrew.Jackson3@cbre.com
0788 795 2215

Chris Thomas
Chris.Thomas3@cbre.com
0780 877 4585

Flude
PROPERTY CONSULTANTS

Mark Minchell
m.minchell@flude.com
01243 929 136

Sebastian Martin
s.martin@flude.com
023 9262 9007

CoLiCo
Living

Disclaimer: Messrs. CB Richard Ellis or Flude Property Consultants for themselves and for the vendors or lessors of this property whose agents they are give notice that: (i) the particulars are set out as a general guideline only for the guidance of intending purchasers or lessees and do not constitute, nor constitute part of an offer or contract. (ii) all descriptions, dimensions, references to condition and necessary permission for use and occupation, and other details are given in good faith and are believed to be correct but any intending purchasers or tenants should not rely on them as statements or representation of fact but satisfy themselves by inspection or otherwise as to the correctness of each of them. (iii) no person in the employment of Messrs. CB Richard Ellis or Flude Property Consultants has any authority to make or give any representation or warranty whatever in relation to this property. (iv) all rentals and prices are quoted exclusive of VAT. April 2021. Designed by Barques barques.co.uk