

**Site Orientation**  
 Position (x,y)  
 The survey grid is a local grid coincident with Ordnance Survey National Grid. Computed using Leica Smartnet RTK network.  
 Level (z)  
 All Orthometric Heights are related to OSGM02 GPS Datum Computed using Leica Smartnet RTK Network.

**Notes**

1. Surveyed boundary features are not necessarily legal boundaries.
2. All information contained in this drawing (including digital data) should be checked and verified prior to any fabrication or construction.
3. Copyright of all data produced by Vertex Surveys shall remain with Vertex Surveys unless otherwise specifically agreed.
4. All utilities have been identified to the best of the surveyors knowledge. The correct identification of the utility types can not be 100 percent guaranteed, therefore these should be independently verified prior to use in any design and building works. All pipe diameters and levels are assumed to be correct, however due to non entry to inspection chambers, these should be verified before any works commence. All drainage connections shown are sounded only. They have not been water tested. Services may be obscured by parked cars, leaf litter or building materials etc.
5. External eaves levels are surveyed to lowest tile position.

**Legend:**

Height & Levels (suffix L)	Levels	Features	Symbols																								
Arch Crown Arch Spring Casing False Ceiling Door Head Door Sill Underside of Beam Underside of Blocking Landscape Window Sill Window Head	ACLU ASLU CSL CFL DHL DSL LBSL LBSLU LBSLU WLSL WLSLU	Boiler Column Culvert Ceiling Hatch Downpipe Damp Proof Course Electrical Control Unit Gas Pipe Gully Inspection Cover Sanitary Pipe Soil Vent Pipe Tank Water Cylinder	<table border="1"> <tr><td>B</td><td>Pipe Floor to Ceiling</td></tr> <tr><td>CC</td><td>Pipe into Floor</td></tr> <tr><td>CH</td><td>Pipe into Ceiling</td></tr> <tr><td>CP</td><td></td></tr> <tr><td>DPC</td><td></td></tr> <tr><td>ECU</td><td></td></tr> <tr><td>GP</td><td></td></tr> <tr><td>GY</td><td>Sloping or Stepped Ground Features</td></tr> <tr><td>IC</td><td></td></tr> <tr><td>ISVP</td><td>Sloping or Stepped Overhead Features</td></tr> <tr><td>ISVP</td><td></td></tr> <tr><td>WVCY</td><td></td></tr> </table>	B	Pipe Floor to Ceiling	CC	Pipe into Floor	CH	Pipe into Ceiling	CP		DPC		ECU		GP		GY	Sloping or Stepped Ground Features	IC		ISVP	Sloping or Stepped Overhead Features	ISVP		WVCY	
B	Pipe Floor to Ceiling																										
CC	Pipe into Floor																										
CH	Pipe into Ceiling																										
CP																											
DPC																											
ECU																											
GP																											
GY	Sloping or Stepped Ground Features																										
IC																											
ISVP	Sloping or Stepped Overhead Features																										
ISVP																											
WVCY																											
Eaves Ridge Flat Roof Inspection Cover Parapet Wall Ridge Structural Gap Top of Wall	EL FL FLL FLL ISL PWL RL SSL TWL																										

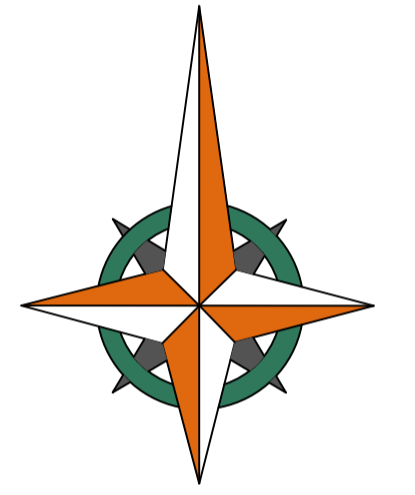

Rev. Suffix	Date	Initial	Revision Details

Client: **The Malins Group**

Location: **Holm Oak Unit 1-4  
Goring-By-Sea  
Worthing, BK12 4FE**

Drawing Title: **GIA Ground Floor Plan**

Job No. 2604008	Dwg No. 2604008-03
Sheet Size A1	Sheets 1 of 2
Scale 1:200	Date April 2026

**VERTEX SURVEYS**  
 SURVEYING/CONSULTING/ENGINEERING

Vertex Surveys Limited  
 51 Paganfields  
 Shere, T. 01483 203 151  
 Guildford, E. mail@vertexsurveysltd.com  
 Surrey, GU5 5HP W. vertexsurveysltd.com

**Federation of Small Businesses**  
 The UK's Leading Business Organisation

**RICS**  
 Registered by RICS

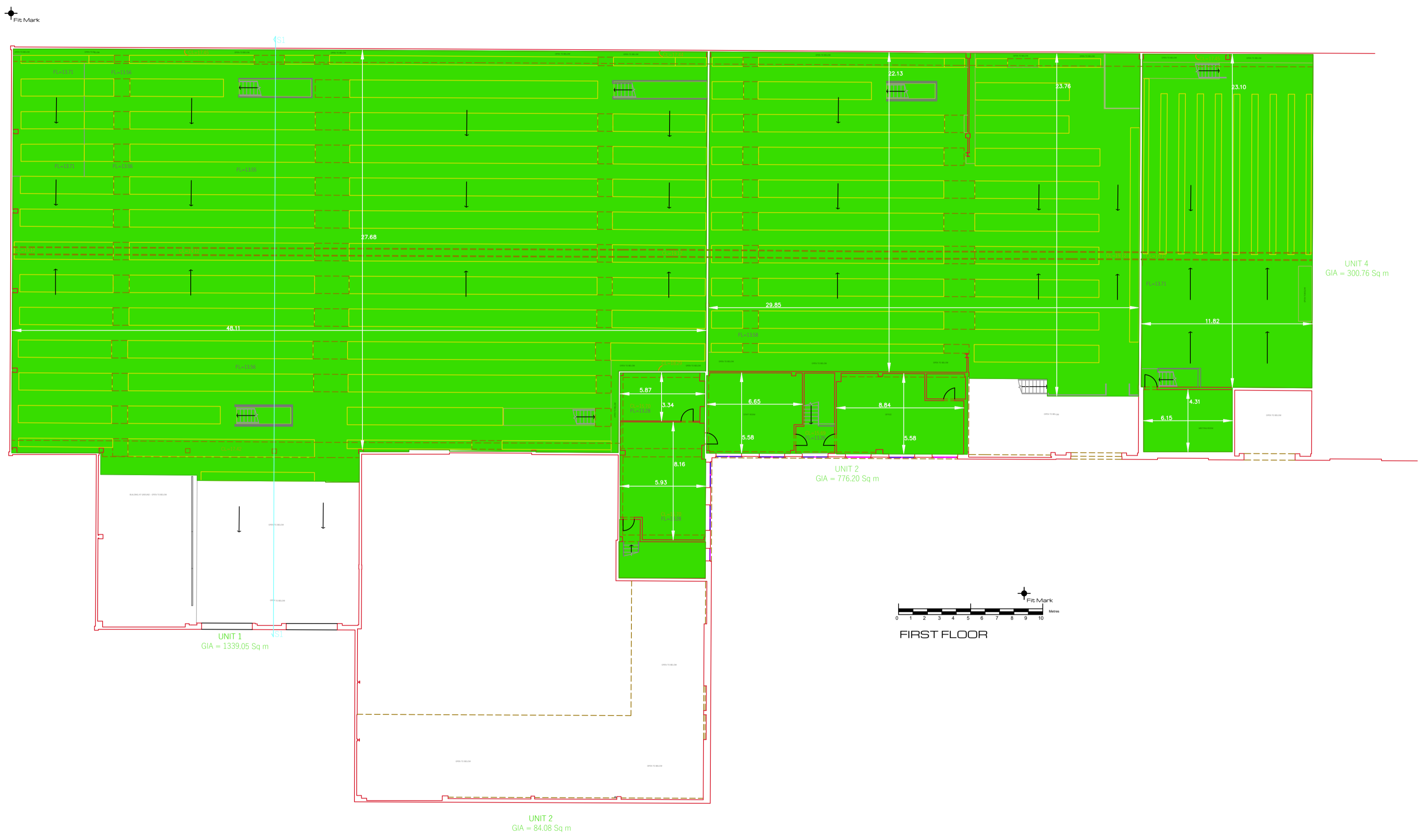

**Site Orientation**

Position (x,y)  
The survey grid is a local grid coincident with Ordnance Survey National Grid. Computed using Leica Smartnet RTK network.

Level (z)  
All Orthometric Heights are related to OSGM02 GPS Datum Computed using Leica Smartnet RTK Network.

**Notes**

1. Surveyed boundary features are not necessarily legal boundaries.
2. All information contained in this drawing (including digital data) should be checked and verified prior to any fabrication or construction.
3. Copyright of all data produced by Vertex Surveys shall remain with Vertex Surveys unless otherwise specifically agreed.
4. All utilities have been identified to the best of the surveyors knowledge. The correct identification of the utility bypass can not be 100 percent guaranteed, therefore these should be independently verified prior to use in any design and building works. All pipe diameters and levels are assumed to be correct, however due to non entry to inspection chambers, these should be verified before any works commence. All drainage connections shown are sounded only. They have not been water tested. Services may be obscured by parked cars, leaf litter or building materials etc.
5. External eaves levels are surveyed to lowest tile position.

**Legend:**

Height & Levels (suffix L)	Levels	Features	Symbols																								
Arch Crown Arch Spring Casing False Ceiling Door Head Door Sill Underside of Beam Underside of Blocking Landscape Window Sill Window Head	AC(L) AS(L) CS(L) CF(L) DH(L) DS(L) UB(L) UL(L) WS(L) WH(L)	Boiler Column Downpipe Ceiling Hatch Downpipe Damp Proof Course Gas Pipe Electrical Control Unit Gully Inspection Cover Sanitary Pipe Soil Vent Pipe Tank Water Cylinder	<table border="1"> <tr><td>B</td><td>Pipe Floor to Ceiling</td></tr> <tr><td>CC(L)</td><td>Pipe into Floor</td></tr> <tr><td>CH</td><td>Pipe into Ceiling</td></tr> <tr><td>CP</td><td></td></tr> <tr><td>DPC</td><td></td></tr> <tr><td>GP</td><td>Sloping or Stopped Ground Features</td></tr> <tr><td>ICU</td><td></td></tr> <tr><td>IG</td><td></td></tr> <tr><td>ICP</td><td>Sloping or Stopped Overhead Features</td></tr> <tr><td>ISVP</td><td></td></tr> <tr><td>ISVP</td><td></td></tr> <tr><td>WVCY</td><td></td></tr> </table>	B	Pipe Floor to Ceiling	CC(L)	Pipe into Floor	CH	Pipe into Ceiling	CP		DPC		GP	Sloping or Stopped Ground Features	ICU		IG		ICP	Sloping or Stopped Overhead Features	ISVP		ISVP		WVCY	
B	Pipe Floor to Ceiling																										
CC(L)	Pipe into Floor																										
CH	Pipe into Ceiling																										
CP																											
DPC																											
GP	Sloping or Stopped Ground Features																										
ICU																											
IG																											
ICP	Sloping or Stopped Overhead Features																										
ISVP																											
ISVP																											
WVCY																											
Eaves Floor Flat Floor Inspection Cover Parapet Wall Ridge Structural Gap Top of Wall	EL FL FLL IC(L) PW(L) RL SG TW(L)																										

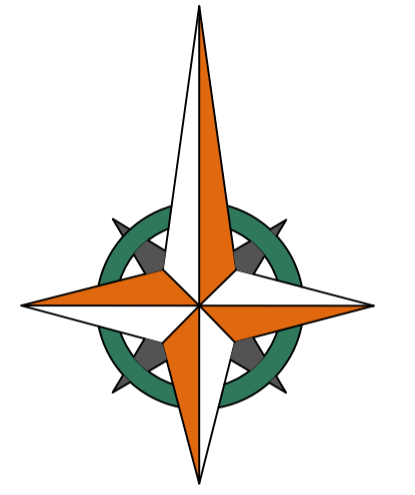

Rev. Suffix	Date	Initial	Revision Details

Surveyor: OH    Drawn By: OH    Checked & Issued By: AJH

**Client:**  
The Malins Group

**Location:**  
Holm Oak Unit 1-4  
Goring-By-Sea  
Worthing, BK12 4FE

**Drawing Title:**  
GIA First Floor Plan

Job No: 2604008    Dwg No: 2604008-02  
 Sheet Size: A1    Sheets: 2 of 2  
 Scale: 1:200    Date: April 2026

**VERTEX SURVEYS**  
SURVEYING/CONSULTING/ENGINEERING

Vertex Surveys Limited  
 51 Paganfields  
 Shere, Guildford, Surrey, GU5 8HP  
 T: 01483 203 151  
 E: mail@vertexsurveysltd.com  
 W: vertexsurveysltd.com

Federation of Small Businesses  
The UK's Leading Business Organisation

**RICS**  
Registered by RICS